

# Collective Remarks

June 2010



A Publication of Houston Dressage Society



## June 2010 President's Message

June 2010 President's Message

### Inside this issue:

Trenna Atkins Seminar	2
Equine Health: Healthy Hooves	4
HorseY Humor	7
Jogging with the HDS Juniors	8
USDF Region 9 News	9
USEF News	11
HDS Schooling Show Results	12
Region 9 Education /Events Calendar	15
Region 9 Recognized Show Calendar	17
HDS Recognized Schooling Show Calendar	18
HDS Classifieds	19

Greetings!

Where did our beautiful spring weather go? 97 degrees looks like it will be staring us in the face for the Summer Show. We are still in need of a few good volunteers. If you can help, please contact Jane Holman at [janeintheneck@aol.com](mailto:janeintheneck@aol.com). Remember that this is a three ring show under cover. We are full up with a waiting list.

The Trenna Atkins Freestyle Seminar will be held on August 7<sup>th</sup> and 8<sup>th</sup> at Rice University's BioScience Research Collaborative Building at the corner of University and Main. The event will be from 9 until 4 each day. Look in the newsletter for additional information.

Jane Holman has graciously agreed to serve as the Nominating Chair for the HDS Board elections to be held in September. If you are interested in serving in one of the open positions, please let Jane know as soon as possible. The open positions that are up for election are President, Vice President, Schooling Show Chair, Junior/Young Rider Chair, Sponsorship and Advertising Chair (Ways and Means), Awards Chair, Historian/Recorder and Special Events Chair. This is your opportunity to make a difference in the operations of HDS.

Mary Kathryn Nommensen, one of our Junior HDS members, has not only qualified for the NAJYRC Region 9 Junior Team for Kentucky, but she is also ranked Number 1 in the country for Junior riders and will be going to Gladstone with her trainer, Anna Burtell, to compete as one of the 12 best junior riders in the country. In addition, HDS junior member from the Dallas area, Rachel Campbell, will be attending Gladstone and competing as one of the best 12 Young Riders in the country. Rachel has represented Region 9 at every USEF National Championship that she was eligible. This will be her last year to compete in both the USEF Championships and the NAJYRC. Both of these young ladies deserve a big hand and a great big "Good Luck".

I am pleased to report that HDS has submitted an application to USEF to host a CDI 1\* next year during the April show. We should find out in June if our application was accepted and sent on to the FEI for final approval. We will be forming several committees to make this show a success. If you are interested in being a part of history in Region 9, please contact me to be a part of one of the planning groups.

As always, please feel free to contact me with those great ideas that will make our club successful.



Photo by TJ Bradford, Austin, TX

**USDF University credit**



## **Trenna Atkins Freestyle Seminar Aug 7-8**

**Attention:** Dressage riders and Judges with dreams of performing or judging a Musical Freestyle, Pas de Deux or Quadrille.

**Topics:** 9:00AM – 4:00PM

- ❖ Judges expectations for single freestyle, Pas de Deux and Quadrilles
- ❖ How to choose music to suit your horse
- ❖ How to use Music software to create and edit your own CD
- ❖ Understanding tempo, phrasing and orchestration
- ❖ Choreography basics – use of space, balance and inventive figures
- ❖ Demonstrations with videos and diagrams

**Location:** Rice University Bio Science Research Collaborative 6500 Main Street, Second Floor “Classroom” (Parking is in the garage below building off Dryden Street. Take garage elevator to 2<sup>nd</sup> floor and follow signs)

**Cost:** \$30 per day or \$50 for both days – HDS members  
\$35 per day or \$60 for both days – Non-members  
*\$5/day discount for early registration received by July 31*

Make checks payable to: “Houston Dressage Society” Mail to HDS, c/o Margaret Dhont  
Horse & Rider, 3821 University Blvd, Houston Tx 77005

## **Houston Dressage Society**

*Dedicated to Furthering the Art of Dressage Through Education*



## DRESSAGE IN THE NEWS

# Trenna Atkins Freestyle Seminar Aug 7-8

**USDF University credit**



Trenna is also interested in receiving a few DVDs of horse(s) showing all three gaits in both directions and including any required figures for that level. (This is not mandatory to participate in the seminar).

**NOTE:** Trenna does not need tapes of existing freestyles, just tapes of the horses, riding normally without music. She wants tapes of horses, and preferably two to four horses, riding walk, trot, canter on both hands. They can be side by side, or in a line. It is best when similar in gait and stride.

If there are horse(s) working together at a certain level (remember, the freestyle level of multiple horse entries is always that of the lowest-level horse), it would be good to include figures and movements as well, for example, half pass, shoulder-in, haunches -in, counter changes, flying changes, etc.--whatever the required figures of that level are.

**Please send tapes by July 7 to:**

**Trenna Atkins  
21308 SR 20  
Coupeville, WA 98239**

**For More information contact:** Karen Peacock [peacocktx@gmail.com](mailto:peacocktx@gmail.com) or  
Karen Sannan [Karen\\_sannan@yahoo.com](mailto:Karen_sannan@yahoo.com)

**About the Instructor:** Trenna Atkins has been instructing and training Dressage for over 35 years, riding and competing horses from Training through FEI. Trenna has been a USEF judge since 1986 and has been a "Senior" rated judge for 9 years. As a rider, Trenna earned her Bronze and Silver medals with USDF and has won Regional and National awards, including two National USDF Horse of the Year Awards in Musical Freestyle. Many of Trenna's students have also won USDF Regional Championships and have achieved their USDF medals. Her instructing includes many adult amateurs, FEI young riders, and eventing students and enjoys teaching all levels of dressage.

In 2003, Trenna became part of the Faculty for the Learner Judges Program of USDF and is especially interested in helping to improve the use of multimedia in training Dressage Judges.

## Houston Dressage Society

*Dedicated to Furthering the Art of Dressage Through Education*

# Equine Health & Wellbeing "A healthy horse is a happy horse"

## Healthy Hooves, Inside and Out

(Continued from page 13)

Farriers are often expected to cup out soles when trimming, but removing the sole callus removes protection of internal structures, including solar blood vessels. When the sole is too thin, these blood vessels recede and, thus, the sole doesn't get the nutrients it needs to recover; growth slows to a crawl. Problems aren't just external; internal bruising, a compressed digital cushion and circulation, lameness, and poor wall growth can result as well in these "flat tire" feet.

Between the sole and wall is the white line, which is actually yellowish-brown and lies just inside the inner white portion of the wall. When small, dark fissures appear in this area, there is cause for concern. These cracks allow dirt and bacteria to access the sensitive areas of the hoof, resulting in abscesses (termed "gravel"). Less-than-adequate hoof mass contributes to this problem.

Last but not least, there's the wedge-shaped frog. It lies in the back of the foot and is slightly more flexible than the wall and sole, and its shape and depth vary greatly in healthy feet. In wet conditions, the frog will be rubbery; in dry conditions, it is very hard and calloused. The healthy frog generally does not need to be trimmed; frogs will periodically shed in some horses. In dry weather irregular tags of loose frog help retain a little moisture so I leave them alone, but in wet conditions I trim these out and any other irregular part of the frog that might be trapping mud, moisture, and bacteria.

### Inside the Healthy Foot

A horse's hooves reflect the shape and health of the structures inside them and can significantly influence that health in turn. We won't detail all the foot's anatomy here, but we will discuss parameters you'll see on a soft-tissue radiograph and what they tell you about the health of that foot (keep in mind that all of these parameters vary with age, breed, and foot size). These parameters can change long before any changes are visible externally, so it can pay great dividends to monitor them, especially with severe problems like laminitis.

**Horn-laminar (HL) zone** is expressed as two numbers denoting the distance between the coffin bone (third phalanx or P3) and the outer hoof wall just under the extensor process and at the bone's tip. This zone consists of horn (wall) and laminae divided approximately 50/50 with most breeds. Typical light-boned breeds (except Standardbreds) will have a healthy HL zone of 15/15 mm (upper measurement/lower measurement), while heavier, older horses such as stallions and broodmares often have HL zones of 20/20 mm.

**Significance** The HL zone tells you a lot about the health of the laminae, particularly with sequential radiographs over time.

If the lower measurement is smaller in an adult horse, the toe has been backed up (by rasping the toe from the front of the hoof wall to shorten it). If the lower one is larger, the horse might have laminitis or white line disease, or he might have a club foot with a thickened H (horn) side of the HL zone due to the heel being repeatedly taken down to try to make the club disappear. An experienced clinician can tell the difference. Lastly, a sudden, uniform increase in both numbers compared to a previous X ray means the laminae are swelling; this indicates early, acute laminitis.

**Palmar angle (PA)** measures the angle the wings of the coffin bone make with the ground. When the wings are parallel to the ground, this is a zero-degree PA. When the wings are higher than the apex, it's a positive PA; a negative PA means they are lower. The PA can vary greatly between horses and even among the feet of the same horse.

**Significance** Most breeds are healthiest with a slightly positive PA; a zero or negative PA indicates some degree of heel crushing with subsequent pain, and most will have a broken-back hoof-pastern axis. This combination, coupled with a thin sole, can cause soundness concern

## SOFT TISSUE PARAMETERS OF THE HOOF

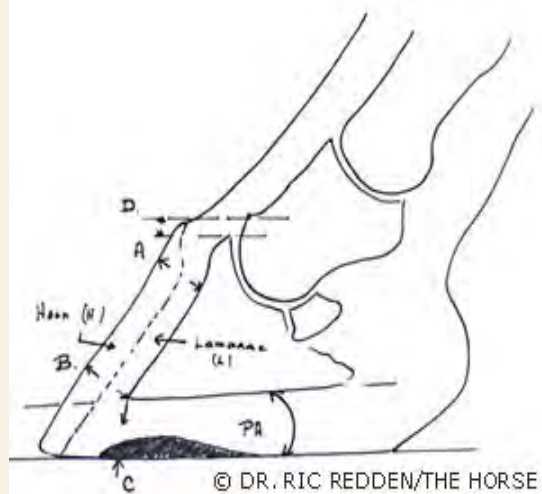

### Measure:

- Horn-laminar (HL) zone (from outer hoof wall to coffin bone) at A and B
- Sole depth (SD) at C (add cup of sole; 12 mm sole + 3 mm cup = 15 mm SD)
- Palmar angle (PA, angle the wings of the coffin bone make with ground)
- Coronary band-extensor process (CE) at D

(Continued on page 15)

## Healthy Hooves, Inside and Out

By Ric Redden, DVM, with Christy West

March 01 2008, Article

### *Do your horse's hooves have these healthy characteristics?*

Much has been written about the equine foot, yet many of us know little about how it's really supposed to look and work. Sound horses don't all have the same size or shape feet (just like humans), and that fact often makes it more difficult to understand the healthy foot's form and function.

This means we can't use a one-size-fits-all approach to say what makes a healthy foot. We have to learn about how the horse's foot is built and how it works, and we must understand how individual variation changes the equation. With that understanding, we can look at our horses' feet and identify characteristics that are healthy, and those that hint at problems in the making.

### **Outside of the Healthy Foot**

The healthy hoof wall is a semi-rigid, keratinized (nonsensitive) structure that protects underlying structures and supports weight along with the sole and frog. It has a hard, dense, naturally polished surface with distinct tubules that run straight (not flared) from the coronary band (at the hairline) to the ground. The wall should be intact, not cracked or chipped, and it should have a dense, tight tubular pattern. The toe is the thickest part of the wall and should be at least three-eighths of an inch thick in most mature breeds. It thins at the widest point of the foot and thickens again as it reaches the turning point at the heel.

Healthy adult hooves normally are wider at the ground than at the coronary band, but foals have feet that are narrower at the ground.

Growth rings, where they haven't been rasped off, provide valuable information on the health of the foot. They should be evenly spaced around the foot, indicating that toe and heel growth are equal (each ring shows about 30 days' growth). A narrow pattern in one area indicates slower growth due to reduced circulation; this could be from overloading as a result of poor conformation and/or balance, injury, or disease. (Note that slightly narrower growth rings on the medial or inner side of the foot are common due to asymmetrical loading from the horse's limbs being placed at the body's corners; this is not normally a cause for concern.) Hoof angles are a function of conformation of external as well as internal structures, age, breed, load, growth rate, and environmental conditions. We'll get to the internal structures in a bit.

The heels form an angle significantly lower than the toe angle on all horses. This doesn't mean all horses have underrun heels; wide variations in healthy heel and toe angles exist between the various breeds. Heels are low and underrun when they progressively

collapse, pushing the ground surface of the foot farther and farther out in front of the heels.

There is no global perfect hoof angle; watch your horse's feet to tell you what works. If you have improving wall thickness, increasing sole depth, and stronger heels with your trimming/shoeing program, then you're on the right track.

The heel bulbs might be symmetric, or one might be pushed up higher than the other, and it's almost always the medial (inner) side (that's higher). It's not necessarily unhealthy until the heel tubules start to collapse, show signs of excessive loading, and diminish growth. This sets the stage for bruising and quarter cracks (pathology in the foot). Pushed-up heels are associated with conformational flaws and, therefore, are often very difficult to manage.

Now let's pick up the horse's foot to look at its ground surface. At the heel bulbs, the wall folds inward, forming the bars. This is a very wide, strong area of the capsule in the healthy foot.

The bars on healthy, bare feet often appear much stronger and more durable than those in the healthy, shod foot. When small, hairlike projections appear under the shoe in this area, they are the first indicators that the heel is becoming weak. They are the heel tubules that are literally fraying and separating from each other as the wall breaks down.

Unfortunately, hard-working equine athletes often beat their heels

into oblivion, jeopardizing their soundness, their careers, and even their lives. More research is needed on how to strengthen weak feet, but I feel that heel degeneration starts with inadequate sole depth and compromised circulation.

The sole protects the sensitive structures inside the foot and houses many blood vessels, thus playing a vital role in the overall health of the foot. The conformation of the sole varies greatly among healthy feet, from being very concave (deep), to shallow with a small natural cup or none at all.

In the bare foot, the outer sole is calloused, tough, and dense. The shod foot's sole will look quite different; the sole will have a softer, flaky zone of exfoliated sole that might fall out easily. Its function as a protective shell has been altered by protective shoes, pads, etc.

*(Continued on page 14)*

### **THE MYTH OF MATCHING FEET**

Most horses do not have perfectly matching feet. Why? Often, the shapes of the coffin bones inside them are very different. When the bone angles vary by up to 15°, is it any wonder that the hooves are shaped differently?

Matching hoof angles when bone angles are significantly different has an inherent risk of causing unwarranted lameness because the forces within the foot are drastically altered.

If you try to make feet like these match externally, you might create a lameness problem. It's a mistake to think that forcing one to match the other or making both conform to a vague standard will make them healthier. A horse's feet can be perfectly healthy and functional at very high levels of competition without matching each other or some "perfect" standard. They just have to be in equilibrium with their internal structures to stay "happy."

*—Ric Redden, DVM, with Christy West*

# Equine Health & Wellbeing "A healthy horse is a happy horse"

## Healthy Hooves, Inside and Out

(Continued from page 14)

**Significance** The healthy shod foot requires at least 15 mm of sole to protect the vascular supply. Bare feet require slightly less, as the vascular supply is normally compressed tighter against the bone.

**Digital breakover (DB)** is the horizontal distance between the tip of P3 and the breakover point—the forwardmost point of ground contact on a hard surface.

**Significance** When toe length increases, so does DB; this conformation applies increased leverage on various internal structures at breakover. Shortening DB can be accomplished with a variety of shoes. Their efficiency is related to where breakover is located. Backing the toe up fails to significantly reduce digital breakover, and it most often only weakens the hoof capsule. Take into consideration SD, PA, and degree of damage when applying breakover-enhancing shoes.

**Coronary band-extensor process distance (CE)** is the vertical distance from the top of the hoof wall to the top of the extensor process of P3, and this describes the depth that P3 sits within the hoof capsule. This measurement has often been called the founder distance, but this is a misnomer *unless* it is a higher number compared to an earlier CE measurement in a horse that has acute laminitis.

(**Significance** The initial CE measurement is primarily a baseline because there is such a wide variation in healthy CEs (zero to 17 mm). The true significance is if it increases in laminitic cases; this indicates the bony column is unstable within the hoof and sinking.

**Bone angle (BA)** is the angle the bottom of P3 makes with its face at the toe.

**Significance** Most light-breed horses will have a bone angle around 50-51°, but variations of up to 15° can occur between feet on the same horse. Matching feet with such different bones can cause unwarranted problems (see "The Myth of Matching Feet" on page 82).

### Pulling it All Together

Become a student of your horse's feet, evaluating them regularly and systematically. From that you'll gain insight into what they look like in good times and bad, and learn what practices keep them in the "good" range.

By Ric Redden, DVM, with Christy West



**Windy Knoll Farm**

[www.windyknolldressage.com](http://www.windyknolldressage.com)

[franwkf@earthlink.net](mailto:franwkf@earthlink.net)

Fran Dearing: owner—trainer 713-703-9433

**THIS YEAR WKF SHOWS ARE OFFERING NEW "OPPORTUNITY" CLASSES !!!!**

**WHAT ARE OPPORTUNITY CLASSES?????**

**THEY ARE CLASSES THAT ALLOW COMPETITORS TO ENTER TRAINING AND FIRST LEVELS WITHOUT PAYING ANY USEF AND USDF FEES!!!! Call Fran for details!**

*Lowest Entry Fees & Stabling in the Region !! All Classes \$30, even FEI !! Stabling \$85 initial shavings incl.*

- WKF SUMMER SHOW 1... JULY 17, 2010
- WKF SUMMER SHOW 2... JULY 18, 2010  
*Judges: Bill Solyntjes ("S") + (TBA "S")*
- WKF FALL SHOW 1... SEPT 25, 2010
- WKF FALL SHOW 2... SEPT 26, 2010  
*Judges: Tom Poulin ("S") + Gen J. Burton ("S")*
- Last Qualifier for the GAIG/USDF & SWDC Championship

## *How Many Horses Does It Take To Change A Light Bulb?*

- **Thoroughbred:** Who ME?? Do WHAT? I'm scared of light bulbs! I'm outta here!
- **Arabian:** I changed it an hour ago. C'mon you guys - catch up!
- **Quarter Horse:** Put all the bulbs in a pen and tell me which one you want.
- **Standardbred:** Oh for Pete's Sake, give me the darn bulb and let's be done with it.
- **Shetland:** Give it to me. I'll kill it and we won't have to worry about it anymore.
- **Friesian:** I would, but I can't see where I'm going from behind all this mane.
- **Belgian:** Put the Shetland on my back, maybe he can reach it then.
- **Warmblood:** Is the 2nd Level Instruction Packet in English? Doesn't anyone realize that I was sold for \$75K as a yearling, but only because my hocks are bad, otherwise I would be worth \$100K? I am NOT changing lightbulbs. Make the TB get back here and do it.
- **Morgan:** Me! Me! Me! Pleeese let me! I wanna do it! I'm gonna do it! I know how, really I do! Just watch! I'll rewire the barn after, too.
- **Appaloosa:** Ya'll are a bunch of losers. We don't need to change the lightbulb, I ain't scared of the dark. And someone make that darn Morgan stop jumping up and down before I double barrel him.
- **Haflinger:** That thing I ate was a lightbulb? camp. Out in the open like REAL horses.
- **Lipizzaner:** Hah, amateurs. I will change the lightbulb. Not only that, but I will do it while standing on my hind legs and balancing it on my nose, after which I will perform seven flying lead changes in a row and a capriole. Can you do that? Huh? Huh? Didn't think so.
- **Miniature:** I bet you think I can't do it just cause I'm small. You know what that is? It's sizeism!
- **Mustang:** Lightbulb? Let's go on a trail ride, instead.
- **Akhal Teke:** I will only change it if it's my owner's lightbulb and no one else has ever touched it.
- **Andalusian:** I will delegate the changing of the lightbulb to my personal groom after he finishes shampooing my mane and cleaning my saddle, but only on the condition that it is changed for a soft blue or green bulb, which reflects better off my coat while I exhibit my astonishing gaits.
- **Cleveland Bay:** I'm busy. Make the whipper-in and the hounds do it.
- **Saddlebred:** My ears are up already, please, please get the lightbulb away from me! I'm ready to show, really, I promise I'll win!
- **Paint:** Put all the lightbulbs in a pen, tell me which one you want, and my owner will bet you twenty bucks I can get it before the quarter horse.
- **POA:** I'm not changing it. I'm the one who kicked the old one and broke it in the first place, remember? Now, excuse me, I have a grain room to break into.
- **Grade Horse:** Guys? Um, guys? I hope you don't mind, but I went ahead and changed it while you were all arguing.





# JOGGING with the HDS JUNIORS

The HDS Juniors will be publishing a cookbook. Please submit your recipes whether for human or equine consumption, pictures are welcome. Send recipes to: [hdsjuniors@gmail.com](mailto:hdsjuniors@gmail.com)

HDS Juniors and Sonesta Farms will be hosting the First Annual Junior run schooling show on Saturday, September 11, 2010. Want to learn what goes on behind the scenes of a horse show, contact [hdsjuniors@gmail.com](mailto:hdsjuniors@gmail.com) to find out.

HDS Junior Board positions are up for reelection. If you would like to be considered for a position on the board for 2011, please submit a short essay about yourself with your riding accomplishments and what you can bring to the board and what position you are interested in. We will publish all candidates' submissions in the HDS junior's newsletter in October, and elections will be at the Region 9 GAIG/SWDC Championships in November. Please send your submissions to [hdsjuniors@gmail.com](mailto:hdsjuniors@gmail.com)

**Mentor Program** The Show Mentor Program is a new program being introduced by the 2010 HDS Junior Sub Committee. The goal of this new program is to make transitioning to a show easier for a junior. This program is headed up by co-chairs Julia Peacock and Kakay Halle. The show mentor will be there to advise and answer questions that the up and coming junior exhibitor and their family may have prior to the show and also while on the show facility. The mentor will be able to answer questions about issues such as membership and registration needed to compete in different shows, levels, and classes as well as smaller questions such as where the office or stalling is located at the showing facility. The mentor program will be creating documents such as packing checklists to provide to the up and coming junior exhibitor prior to the show.

We are looking for both mentors to help support the program and juniors in need of these services. If you would like to participate in this program as a mentor or are in need of these services or know of someone who is please feel free to contact me, Julia Peacock, at [Julia9311@yahoo.com](mailto:Julia9311@yahoo.com).



When it's time to slow down...

Personal Senior Equine Care  
[www.green-meadow-farm.com](http://www.green-meadow-farm.com)



## **Journey to the Alltech FEI 2010 World Equestrian Games The First Ever ParaWebathon**

Date: June 8, 2010 from 7:00 PM to 9:00 PM

**Purpose:** To raise money and provide awareness for the United States Para-Equestrian team who are attending the Alltech FEI 2010 World Equestrian Games. All monies will be funneled through the United States ParaEquestrian Association to offset the costs of the 10 United States Para-Athletes and their horses attending the Games. Presenting Sponsors: The Horse Radio Network and the 2010 Radio Show, Alltech and the United States ParaEquestrian Association (USPEA).

**Medium:** A live video event streaming to websites all over the horse world. Using USTREAM will make it easy for affiliate websites to promote and carry this first ever "Jerry Lewis like" telethon to raise money for this very worthwhile cause. It is a simple embed code and you are up and running.

**Affiliates:** Websites interested in participating in this event will be able to easily place the live streaming code on their websites. Websites should promote the event ahead of time and encourage their readers to go to their websites to watch the event. Any and all websites are encouraged to participate.

**Hosts:** From the 2010 Radio Show; Glenn the Geek and Samantha Clark, and Para-Equestrian Susan Treabes

**Broadcasting:** This live event will be broadcast from the studios of Alltech. Alltech has kindly donated their studios and technical expertise to put this event on. We will highlight the stories of these inspirational athletes who are likely to compete at their first World Championships.

**The Need:** The 2010 Alltech FEI World Equestrian Games will be the first WEG to offer Para-Equestrian competition. This is a very exciting addition that brings Para-Equestrian to the forefront of the horse world. Unfortunately, the Para teams do not have the resources or sponsors that the other disciplines enjoy. Most of the competitors will have to raise their own funds to attend the WEG this year in Kentucky. For the American team alone this can amount to up to \$20,000 per competitor.

### **How Can You Help?**

- First and foremost, donate during the Webathon on June 8, 2010.
- If you have a website of any kind, please carry the live video on June 8, 2010. It's free and easy.
- Promote this event throughout all your social media and mailing lists.

Contact Glenn at the Horse Radio Network for more details! [glenn@horseradionetwork.com](mailto:glenn@horseradionetwork.com) or 443-553-5063.

## **V O T E N O W !**

Vote today for the Participating Member (PM) Delegates you would like to represent your region! Voting begins on June 1 and will end on June 30. Visit the USDF Web site and login to place your vote, or click on the "Vote" icon. If you would like to request a paper ballot be sent to you in the mail, e-mail or call the USDF office.

## **HISTORICAL AWARDS REPORTS**

If you would like to obtain a summary of all the awards you or your horses have won, you may do so by purchasing a Historical Awards Report. The information contained in this report is perfect for resumes or advertising! Log in to the USDF Web site now to obtain your USDF Historical Awards Report.

## **USDF/DOVER SADDLERY MEDAL PROGRAM**

The USDF/Dover Saddlery Adult Amateur Medal Program is a great opportunity for adult amateurs currently riding at Second Level to receive recognition. New for 2010, the minimum score required to earn a USDF/Dover Saddlery Medal has been raised to 60 percent. More information is available on the USDF Web site.

## **NEED PAST SCORES?**

Past scores may be retrieved for a nominal processing fee. Log in to the USDF Web site to obtain your lifetime score check for a horse or rider now!



---

## **YOU TOO CAN EARN A USDF RIDER AWARD!**

You might already have the scores on file to be awarded a USDF Rider Award! All of the requirements for the Rider Awards Program are located on the USDF Web site. Log in to the USDF Web site and see the 2010 USDF Directory online to learn more.

---

## **DEADLINES**

Do you know somebody worthy of recognition for the hard work they have dedicated to the sport of dressage at the local or national level? Nominate now for the Regional GMO Volunteer of the Year Award or the USDF Volunteer of the Year Award, presented by The Paddock Saddlery. Nominations are due by August 31. Questions?

---

## **YOUTH NEWS**

USDF Nomination for the USEF Youth Sportsman Award  
Applications are now available for active USDF Youth Participating members to be nominated for the 2010 United States Equestrian Federation (USEF) Youth Sportsman’s Award, sponsored by Breyer Animal Creations®. Applications must be submitted to USDF by October 1. An application and details can be found by clicking [HERE](#). Contact [youth@usdf.org](mailto:youth@usdf.org) for more information.

---

## **USDF YOUTH CONVENTION SCHOLARSHIP**

Calling all Youth! The Youth Programs Advisory Subcommittee will be offering up to four USDF Youth Convention Scholarships of up to \$1,000 each to outstanding USDF Youth Participating members. Don’t miss an amazing opportunity to attend the Adequan/USDF Annual Convention and experience USDF behind the scenes as a guest in various youth committee meetings and educational sessions. Applications are available online and need to be submitted by August 15. Contact [youth@usdf.org](mailto:youth@usdf.org) for complete details.

---

## **USDF YOUTH VOLUNTEER OF THE YEAR AWARD**

If you know of a USDF member, 21 years or younger, who has volunteered at least 25 hours, please nominate them for the USDF Youth Volunteer of the Year Award, presented by The Paddock Saddlery! Nominations are due by August 31. Please visit the USDF Web site for nomination forms or contact [youth@usdf.org](mailto:youth@usdf.org) for more information.

---



# USEF NEWS

UNITED STATES EQUESTRIAN FEDERATION : 4047 IRON WORKS PARKWAY, LEXINGTON, KY 40511-8483 : WWW.USEF.ORG



FOR IMMEDIATE RELEASE

## Dancing with the Stars: Welsh Cob Stallion Waltzes to Championship

Release: May 13 2010

Author: By Martha Stover

Welsh Cob stallion North Forks Cardi and rider/trainer/co-owner Jessica Wisdom broke a barrier, a glass ceiling if you will, for Welsh Cobs and large ponies. They won their FEI Intermediaire I Musical Freestyle class at a Concours Dressage Internationale (CDI) at Rancho Murieta, CA, with an impressive 68.5%. The CDI included four Olympic-qualified judges and one International judge. This is the third Concours Dressage Internationale Team Cardi has entered, and the highest score they've yet achieved at a CDI. This win culminated two weeks of competition in California.

At just 14.3 hands, Cardi is proving that size doesn't matter. And that the little guy can end up on top. Congratulations to Cardi and Owners Cindy Miller and Jessica Wisdom of Winterlake Welsh Cob Farm, Pleasant Hill, OR. For more stories about the adventures of "Team Cardi," visit [www.winterlake.com](http://www.winterlake.com).

### Welsh Ponies and Cobs

The Welsh breed offers a variety of solutions to fit the equine needs of young and old. Athletic and hardy, flashy and sporty, intelligent, sound and reasonably easy to keep, a Welsh will find its way into your home and into your heart.

Ranging in height from a diminutive 11 hands to well over 16 hands, the breed is divided into four distinguishable types or "sections," plus Half Welsh, each strictly limited by the percentage and combination of Welsh parentage. In all cases, the general appearance of strong, hardy, "pony-like character" should be evident.

All Welsh Ponies and Cobs registered with the Welsh Pony and Cob Society of America (WPCSA), the governing body of Welsh in the U.S., can trace their ancestry back to their native Wales. It is from Wales that ponies and cobs are still lured back to the states to continually widen the gene pool of this popular breed.

For more information about Welsh Ponies and Cobs, please visit the Welsh Pony and Cob Society of America at [www.welshpony.org](http://www.welshpony.org).



Photo by Team Cardi, LLC

North Fork Cardi and Jessica Wisdom receive the Championship award for I1 Freestyle at Rancho Murieta

*Pam Fowler Grace*

Lessons & Clinics  
Training & Exhibition  
281-785-6498  
[www.PamFowlerGrace.com](http://www.PamFowlerGrace.com)  
HEAR THE MUSIC IN YOUR HEART  
and Dance

# HDS Recognized Schooling Show Results

## Hearthstone Riding Stables May 8, 2010

Date: 8-May-10

Judge: Kim Thompson-Hoblit

Show

Location: Hearthstone Riding StablesShow Manager/Secretary: Rebekah Wesatzke/Jerry Lyons

Division	Level	Test	HDS #	Rider	Horse	Points	Percent	HDS Hi Point Award
Amateur	2nd	3		Jeanette Snow	Lalique Von Foster	267	62.093	
Amateur	Training	1		Mary Hale-Hogue	Mr. Right	128	58.260	
Open	Training	1		Erika West Danque	Ima Pretty Pinup	135	58.695	
JR/YR	Training	1		Emily McBride	Breaux	119	51.739	
JR/YR	Training	1		Victoria Zinkham	Dipper	129	56.086	
Amateur	2nd	4		Jeanette Snow	Lalique Von Foster	261	62.142	
Open	Training	2		Erika West Danque	Ima Pretty Pinup	176	62.857	
JR/YR	Training	2		Emma Patterson	Blue Sprinkles	178	63.571	Hi Point JR/YR
Amateur	Training	2		Mary Hale-Hogue	Mr. Right	160	57.142	
JR/YR	Training	2		Kimberly Luijten	Ebony	168	56.428	
JR/YR	Training	2		Jenny Howie	Save Me	170	60.714	
Open	Training	4		Erika West Danque	Ludwig	250	65.789	
Amateur	1st	4		Stacy Munoz	Zoe	227	59.736	
Amateur	Training	3		Carlanna Cunningham	Rokky	145	58.000	
JR/YR	Training	3		Jessica Tinker	Tico	151	60.400	
JR/YR	Training	4		Jenny Howie	Save Me	125	50.000	
Amateur	Training	4		Mary Hale-Hogue	Mr. Right	154	61.600	
Amateur	Training	4		Carlanna Cunningham	Rokky	132	52.800	
JR/YR	Training	4		Emma Patterson	Blue Sprinkles	154	61.600	
JR/YR	Training	4		Anissa Rincones	Save Me	127	50.800	
Amateur	Training	4		Lynda Langston	Kyra Von Foster	159	63.600	Hi Point AA
Open	1st	1		Erika West-Danque	Mr. Right	187	62.333	
Amateur	1st	1		Lynda Langston	Kyra Von Foster	191	63.666	
JR/YR	Intro	A		Claire Gorsuch	Missy	84	42.000	
Amateur	Intro	A		Cheryl Moran	Shiner Blonde	113	56.500	
Amateur	Intro	A		Belinda Reeves	Wild Magpie	72	46.000	
JR/YR	Intro	A		Maddie Hausmann	Tico	139	69.500	Hi Point JR/YR Intro/GAG
JR/YR	Intro	A		Patsy Serna	Breaux	101	50.500	
Amateur	Intro	B		Cheryl Moran	Shiner Blonde	128	64.000	Hi Point AA Intro/GAG
JR/YR	Intro	B		Caroline Huet	Dipper	111	55.500	
JR/YR	Intro	B		Maddie Hausmann	Tico	136	68.000	
JR/YR	GAG	1		Julia Stein	Missy	94	55.291	
JR/YR	GAG	1		Evie Udstein	Breaux	106	62.353	
JR/YR	GAG	1		Audrey Finck	Tahoe	91	53.529	
JR/YR	GAG	1		Caroline Cook	Missy	99	58.235	
JR/YR	GAG	3		Maddie Hausmann	Tico	144	65.455	
JR/YR	GAG	3		Audrey Finck	Tahoe	129	58.636	
JR/YR	GAG	1		Julie Burt	Breaux	99	58.235	
JR/YR	GAG	1		Alli-Beth Drinmon	Missy	82	48.235	

# HDS Recognized Schooling Show Results

## Solstice Farms May 9, 2010

**Date:** 9-May-10 **Judge:** Diane Rochau  
**Show Location:** Solstice Farms **Show Manager/Secretary:** Marie Morgan

Rider	Division	Level	Test	HDS #	Horse	Points	Percent	HDS Hi Point Award
Alicia Boutan	Amateur	1st	4	639	Clifton Spirit	175	46.053	
Alicia Boutan	Amateur	1st	1	639	Clifton Spirit	156	52.000	
Barbara Stewart	Amateur	2nd	1	597	Usache	214	56.316	
Barbara Stewart	Amateur	1st	4	597	Usache	235	61.842	
Candy Beck-Brake	Amateur	Training	2	138	My Odyssey	177	63.214	
Candy Beck-Brake	Amateur	Training	3	138	My Odyssey	159	63.600	
Candy Beck-Brake	Amateur	Training	4	138	My Odyssey	163	65.200	
Carlanda Hassoldt	Amateur	Training	1	526	Solstice Farms Loverboy	149	64.783	
Dana Bogatin	Amateur	1st	1	Yes	Captain Jack Sparrow	178	59.333	
Dana Bogatin	Amateur	Training	3	Yes	Captain Jack Sparrow	157	62.800	
Dana Bogatin	Amateur	Training	4	Yes	Captain Jack Sparrow	151	60.400	
Debora Botting	Amateur	1st	1	733	Red Kenya	196	65.333	
Debora Botting	Amateur	1st	2	733	Red Kenya	228	63.333	
Diane Dougherty	Amateur	3rd	1	607	Ducati CH	233	59.744	
Diane Dougherty	Amateur	3rd	2	607	Ducati CH	248	63.590	
Emee Ermel	Amateur	1st	1	753	Genuwine Solstice	206	68.667	HDS Hi Point AM Award
Emee Ermel	Amateur	Training	4	753	Genuwine Solstice	170	68.000	
Holly Harrison	Junior	Training	1	Yes	Shadow Eclipse	133	57.826	
Holly Harrison	Junior	Training	2	Yes	Shadow Eclipse	172	61.429	HDS Hi Point JR Award
Isabella Vrazel	Amateur	1st	1	791	Tri Bar Paloma	176	58.667	
Isabella Vrazel	Amateur	Training	4	791	Tri Bar Paloma	162	64.800	
Jeanette Snow	Amateur	2nd	3	99	Lalique Von Foster	256	59.535	
Jeanette Snow	Amateur	2nd	4	99	Lalique Von Foster	261	62.143	
Karen Traill	Amateur	Training	2		Forrest	173	61.786	
Karen Traill	Amateur	Training	4		Forrest	133	53.200	
Karla West-Dee	Amateur	1st	3	633	Enchanted Love Affair	202	57.714	
Karla West-Dee	Amateur	1st	4	633	Enchanted Love Affair	225	59.211	
Karla West-Dee	Amateur	1st		633	Enchanted Love Affair	176	73.330	USDF Freestyle 1
Linda Orlando	Amateur	Intro	A		Isaac	136	68.000	
Linda Orlando	Amateur	Intro	B		Isaac	140	70.000	
Mandi Krasney	Amateur	Training	4		Ute	164	65.600	
Megan Dougherty	Amateur	Training	2		On Broadway	155	55.357	
Megan Dougherty	Amateur	Training	3		On Broadway	141	56.400	
Michelle Johnson	Junior	Intro	A	Yes	Excalibur	127	63.500	
Michelle Johnson	Junior	Intro	B	Yes	Excalibur	131	65.500	HDS Hi Point GAG/INTRO Medal Junior
Paula Woody	Amateur	1st	2		OO7	184	51.111	
Paula Woody	Amateur	1st	1		OO7	161	53.667	
Paula Woody	Amateur	Training	4		OO7			
Robin Malone	Amateur	Training	1	583	Crown Jewel	132	57.391	
Robin Malone	Amateur	Training	2	583	Crown Jewel	162	57.857	
Trina Schukar	Amateur	Intro	A	893	"Reny" Smokin N Loping	133	66.500	HDS Hi Point GAG/INTRO Medal Amateur
Trina Schukar	Amateur	Intro	B	893	"Reny" Smokin N Loping	124	62.000	

# HDS Recognized Schooling Show Results

## Freestyle Farms May 2, 2010

<b>FREESTYLE</b>	<b>FARM</b>	<b>SHOW</b>	<b>RESULTS</b>	
<b>May 2, 2010</b>				
<b>test</b>	<b>rider</b>	<b>number</b>	<b>horse</b>	<b>score</b>
2/3 Am	J. Snow	#72	Lalique VF	274/63.720% (1)
1/3 Open	H. Flint	#73	In Disguise	218/62.285% (1)
1/3 Open	C. Harmon	#74	Mr. Wilton	215/61.428% (2)
2/4 Am	K. Bruce	#70	Wicklow	260/61.904% (2)
2/4 Am	J. Snow	#72	Lalique VF	276/65.714% (1)
1/1 Am	L. Langston	#75	Kyra VF	190/63.333% (1)
1/4 Open	H. Flint	#73	In Disguise	235/61.842% (1)
1/4 Open	C. Harmon	#74	Mr. Wilton	227/59.737% (2)
2/2 Am	K. Bruce	#70	Wicklow	237/64.054% (1)
1/4 Am	L. Langston	#75	Kyra VF	245/64.473% (1)
1/4 Am	S. Roberts	#77	Lagniappe	239/61.842% (3)
1/4 Am	S. Munoz	#78	Cassanova	244/64.211% (2)
1/2 Junior	S. Jones	#76	De Beer	241/66.940% (1)
1/2 Junior	S. Jones	#82	Twelfth Hour	229/63.611% (2)
1/2 Am	S. Roberts	#77	Lagniappe	<i>scratch</i>
1/2 Am	S. Munoz	#78	Cassanova	228/63.333% (1)
1/3 Junior	J. Fan	#79	Madoc P. Phillip	229/65.429% (1)
1/1 Junior	K. Raisbeck	#80	Las Vegas	191/63.667% (1)
1/1 Junior	E. Hart	#81	Master Cool	186/62.000% (2)
1/4 Junior	S. Jones	#76	De Beer	241/63.421% (3)
1/4 Junior	J. Fan	#79	Madoc P. Phillip	254/66.842% (1)
1/4 Junior	K. Raisbeck	#80	Las Vegas	235/61.842% (4)
1/4 Junior	S. Jones	#82	Twelfth Hour	245/64.474% (2)
T/4 Junior	E. Hart	#81	Master Cool	165/66.000% (2)
T/4 Junior	H. Linton	#83	Coppertone	169/67.600% (1)
1/1 (HC)	K. Stanka	#84	Black Jack	193/64.333%
T/1 Am	C. Brake	#85	My Odyssey	149/64.782% (1)
T/1 Am	S. Dubicki	#86	Valiente Corazon	134/58.261% (3)
T/1 Am	J. Jamison	#87	Tidal Wave	145/63.043% (2)
T/1 Junior	H. Linton	#83	Coppertone	158/68.696% (1)
½ (HC)	K. Stanka	#84	Black Jack	228/63.333%
T/2 Am	C. Brake	#85	My Odyssey	178/63.571% (3)
T/2 Am	S. Dubicki	#86	Valiente Corazon	177/63.214% (4)
T/2 Am	J. Jamison	#87	Tidal Wave	176/62.857% (5)
T/2 Am	T. Vozar	#88	Diazolical	182/65.000% (2)
T/2 Am	K. Sanaan	#89	Gratuity	193/68.929% (1)
T/3 Am	C. Brake	#85	My Odyssey	164/65.600% (2)
T/3 Am	B. Hansberry	#90	Shay Darra	168/67.200% (1)
T/3 Am	L. Bryla	#91	BondadosaTSF	151/60.400% (3)
T/3 Am	F. Bryla	#92	Bolero	145/58.000% (5)

# Events Calendar - Clinics & Events

## JUNE 2010

6	"Dancing with the Stars" fundraiser for Region 9 NAYRC Teams	Paragon Stables, Conroe, TX	\$25 adults \$15 ages 12 & under	Joan Darnell 512-868-1814 <a href="mailto:joan@dressage.us">joan@dressage.us</a>
8-9	Pam Goodrich	Windy Knoll Farms, Magnolia, TX	Auditors Welcome-No Fee	Fran DearingI 713-703-9433 <a href="mailto:franwkf@earthlink.net">franwkf@earthlink.net</a>
19-20	Tom Noone	Southernwood Farm, Conroe, TX		Mary Nuttall 281-382-0766
19-22	Jeff Moore Biomechanics Clinic	Near Houston, TX		Virginia Neal Ellis 713-694-0694 <a href="http://www.equestrianventures.com">www.equestrianventures.com</a>
24	Regan Golob Bio Energy Clinic	Houston Mounted Patrol Facility, Houston, TX	Proceeds to benefit Houston Mounted Patrol	Pam Church 936-449-4096 or cell 713-206-5215 <a href="mailto:gaitsforglory@gmail.com">gaitsforglory@gmail.com</a>
22-23	Tom Poulin	Windy Knoll Farms, Magnolia, TX	Auditors Welcome-No Fee	Fran DearingI 713-703-9433 <a href="mailto:franwkf@earthlink.net">franwkf@earthlink.net</a>
26-27	Pati Pierucci	Rosehill Ranch, Tomball, TX	Auditors welcome - \$20/day	Annie McChesney 281-433-8208 <a href="mailto:annie-14@sbcglobal.net">annie-14@sbcglobal.net</a>

## JULY 2010

23-24	Pati Pierucci	Rosehill Ranch, Tomball, TX	Auditors welcome - \$20/day	Annie McChesney 281-433-8208 <a href="mailto:annie-14@sbcglobal.net">annie-14@sbcglobal.net</a>
24-25	Tom Noone	Southernwood Farm, Conroe, TX		Mary Nuttall 281-382-0766

# Events Calendar - Clinics & Events

## AUGUST 2010

7-8	Trenna Atkins Freestyle Clinic	Rice University Houston, TX	HDS Members: \$30/per day or \$50 for both days; Non- members: \$35/day or \$60 for both days	Susan Howard 512-423-4424 <a href="mailto:reiterhof@googlemail.com">reiterhof@googlemail.com</a>	HDS Recognized  INFO
-----	-----------------------------------	--------------------------------	---	--	-------------------------------

## OCTOBER 2010

9- 10	Paul Kathen Dressage Workshop	Tex-Over Farms Conroe, TX		Tex-Over Farms <a href="http://www.tex-overfarms.com">www.tex-overfarms.com</a>	
16- 19	Jeff Moore Biomechanics Clinic	Houston, TX		Virginia Neal Ellis 713-694-0694 <a href="http://www.equestrianadventures.com">www.equestrianadventures.com</a>	
16- 17	Steffen Peters Symposium	Aubrey, TX		Contact: Lyndon Rife 281-221-0544 <a href="http://www.lyndonrifedressage.com">www.lyndonrifedressage.com</a>	
23- 24	Tom Noone	Southernwood Farm, Conroe, TX		Mary Nuttall 281-382-0766	

## NOVEMBER 2010

20- 21	Karen Robinson Freestyle Clinic	Willow Fork Ranch, Katy, TX		Sandra Adair <a href="mailto:stadair@comcast.net">stadair@comcast.net</a>	
-----------	------------------------------------	--------------------------------	--	--	--

## DECEMBER 2010

4-5	Tom Noone	Southernwood Farm, Conroe, TX		Mary Nuttall 281-382-0766	
-----	-----------	-------------------------------------	--	------------------------------	--

## REGION 9 RECOGNIZED SHOW CALENDAR

For competition information additions & updates contact Bess Reineman

JUNE 2010	
12-13	<b>HDS Summer Shows I &amp; II</b> , Katy, TX Kathy Jones ( <a href="#">email</a> ) ; <i>Adult Team Competiton</i> ; <i>NAJYRC Qual.</i> ; <a href="http://www.ShowSecretary.com">www.ShowSecretary.com</a>
19-20	<b>11th Annual Green Country Dressage Classic</b> , Claremore, OK Anne Kuhns ( <a href="#">email</a> ) Youth Team Competition ; Adult Team Competition; <i>NAJYRC Qual.</i> ; <a href="http://www.greencountrydressage.org">www.greencountrydressage.org</a>
JULY 2010	
9-11	<b>Blues City Dressage</b> , Memphis, TN Sandy Donovan ( <a href="#">email</a> )
17-18	<b>Windy Knoll Farm Summer Dressage Show</b> , Magnolia, TX Judges CARTER BASS (S) AND BILL SOLYNTJES (S). Opportunity Classes offered. Fran Dearing ( <a href="#">email</a> )
31-Aug 1	<b>DDC Lemonade Daze I &amp; II</b> , Irving, TX Michelann Tachibana ( <a href="#">email</a> )
AUGUST 2010	
21-22	<b>Lazy E Dressage Classic I &amp; II, &amp; Great Plains Championships</b> , Guthrie, OK Stacia Wert-Gray ( <a href="#">email</a> )
28	<b>Alamo Dressage Association, San Antonio Fall Dressage Show I &amp; II</b> , Boerne, TX Jan Colley ( <a href="#">email</a> )
SEPTEMBER 2010	
4-5	<b>HDS Laborious Day Shows I &amp; II</b> , Conroe, TX Kathy Jones ( <a href="#">email</a> )
11-12	<b>"Reiterhof at San Antonio Rose Palace"</b> , Boerne, TX Susan Howard ( <a href="#">email</a> )
18-19	<b>DDC Yellow Rose I &amp; II</b> , Irving, TX Michelann Tachibana ( <a href="#">email</a> ) 2011 <i>NAJYRC Qual.</i> ; <a href="http://www.dallasdressage.org">www.dallasdressage.org</a>
19	<b>Topsider Farm Dressage Two</b> , College Station, TX Ginni Cifelli ( <a href="#">email</a> )
24-26	<b>Texas Dressage Fall Classic I &amp; II</b> , Tyler, TX Kim Brunson ( <a href="#">email</a> ) or Susan Peacock ( <a href="#">email</a> )
25-26	<b>Windy Knoll Farm Fall Dressage Show</b> , Magnolia, TX Judges TOM POULIN (S) AND GEN. J. BURTON (S) Opportunity classes offered. Fran Dearing ( <a href="#">email</a> ) 2011 <i>NAJYRC Qual.</i> ; <a href="http://www.windyknolldressage.com">www.windyknolldressage.com</a>
25-Oct. 10	<b>World Equestrian Games</b> , Kentucky Horse Park, Lexington, KY. Tentative Dressage dates are Sept. 26-Oct. 1. (For your planning purposes.)
NOVEMBER 2010	
4-7	<b>GAIG/ USDF Regional Championships / SWDC HDS Dressage Show</b> , Katy, TX Kathy Jones ( <a href="#">email</a> ) 2011 <i>NAJYRC Qual.</i> <a href="http://www.houstondressagesociety.org">www.houstondressagesociety.org</a> (Shows, take note...last weekend to qualify would be September 25-26, 2010. Deadline for entries wouldbe September 29, 2010. But, a show could apply for the special exemption that would allow the next weekend.)
13-14	<b>Turkey Trot Dressage</b> , Clifton Farms, Hernando, MS.- Sandy Donovan ( <a href="#">email</a> )

JUNE 2010						
6/6/2010	All Heart Horse Farm	HDS-Recog	Manvel, TX	Lelsie Cummings	Heidi Ziemer 713-515-1261	<a href="#">Website</a>
6/19/10	BACH/Topsider Dressage Series Three	HDS-Recog	College Station, TX	Julie Berry	Ginni Cifelli <a href="mailto:ginni@flash.net">ginni@flash.net</a> 979-690-6788	
6/19/10	CTDS Mini Show - "Heat Wave"		Silver Hill Stables, Manor, TX	Bess Reineman	Cynthia Castleberry, Linda Lattanzio, Jessica Wright - Co-Managers <a href="#">Website</a> <a href="mailto:swinginghorses@earthlink.net">swinginghorses@earthlink.net</a>	
6/26/10	Hearthstone Riding Stable	HDS-Recog	Houston, TX	Grace Harris	Rebekah Wesatzke, Show Manager 281-398-1665 Jerry Lyons, Show Secy 713-516-0211 <a href="mailto:jlyons1a@comcast.net">jlyons1a@comcast.net</a> <a href="#">Website</a>	<a href="#">Entry Form</a>

JULY 2010						
7/11/10	Freestyle Farm	HDS-Recog	Fulshear, TX	Leslie Cummings	Christy Raisbeck <a href="mailto:trabour@aol.com">trabour@aol.com</a> <a href="#">Website</a>	
7/24/10	BACH/Topsider Dressage Series Four	HDS-Recog	College Station, TX	Grace Harris	Ginni Cifelli <a href="mailto:ginni@flash.net">ginni@flash.net</a> 979-690-6788	

SEPTEMBER 2010						
9/11/10	Sonesta Farms	HDS-Recog	Cypress, TX	Leslie Cummings	Rebecca Pennington <a href="http://www.sonestafarms.com">www.sonestafarms.com</a> 281-373-9125	<a href="#">Entry Form</a>
9/19/10	Freestyle Farm	HDS-Recog	Fulshear, TX	Pam Grace	Christy Raisbeck <a href="mailto:trabour@aol.com">trabour@aol.com</a> <a href="#">Website</a>	
9/25/10	CTDS Mini Show - "Sock Hop"		Silver Hill Stables, Manor, TX	Clare Morrow	Cynthia Castleberry, Linda Lattanzio, Jessica Wright - Co-Managers <a href="#">Website</a> <a href="mailto:swinginghorses@earthlink.net">swinginghorses@earthlink.net</a>	

OCTOBER 2010						
10/9/10-10/10/10	Sienna Stables	2 day show!  HDS-Recog	Missouri City, TX	1-Leslie Cummings  2-Diane Rochau	Cal Eller, Show Manager 281-723-4009 <a href="mailto:celler78@aol.com">celler78@aol.com</a> Laura Eller, Show Secy 281-778-7433 <a href="mailto:laura@siennastables.com">laura@siennastables.com</a> <a href="#">Website</a>	<a href="#">Show Bill</a>  <a href="#">Entry Form</a>
10/16/10	Hearthstone Riding Stable	HDS-Recog	Houston, TX	TBD	Rebekah Wesatzke, Show Manager 281-398-1665 Jerry Lyons, Show Secy 713-516-0211 <a href="mailto:jlyons1a@comcast.net">jlyons1a@comcast.net</a> <a href="#">Website</a>	<a href="#">Entry Form</a>

# HDS CLASSIFIEDS

<b>HORSES</b>	
For 1/2 Lease: Two Horses located in Katy, Texas west of Katy Mills Mall. First horse is a 15 year old 15.1 gelding Welsh Cob cross, Knows 3rd level movements but doesn't have lead changes. Easy to sit, has a fun personality. 2nd horse is a 13 year old unraced TB, 16.1 mare. Takes up a lot of leg, is smooth and easy to ride. Nice lower level horse. Both horses are available for showing to the right rider. Neither horse is suitable for a beginner rider but would work for a confident junior or adult amateur. For more information please contact Andrea at 281-610-1334 or <a href="mailto:andrea@piecedart.com">andrea@piecedart.com</a> .	5/11/10
<b>For full or 1/2 lease:</b> "Rokkstar"-10 year old gelding,15.2 hands,1/2 Arab-1/2 Hanoverian.Very flashy chestnut with 4 white socks and a blaze.Was 2nd Level HDS Champion(with a junior rider).Great gaits & very sweet.Requires a confident rider.Must stay at Hearthstone Riding Stables-lessons available. For info contact:charlagipson@yahoo.com	4/10/10
<b>Wanted dressage horse to lease.</b> Must be sound and sane. Would prefer School master, but I have an open mind, and good seat. Will ride in clinics with Heather Blitz and Joanie Bolton when in town. Will be kept @ facility w/ covered arena, huge turnout pastures, and trails in Tomball. Teri @ 713-398-6519	3/24/10
<b>For Sale:</b> Dutch gelding, rising 4 years. Bright orange chestnut, 4 white socks and a full blaze, he is very bling! Imported last fall, he is currently 16.3, but is fairly narrow. Exceptionally trainable temperament, friendly and affectionate to handle. He is built very uphill, and has amazing balance for such a young horse - his canter is incredible. By Silverstone ex Goodtimes mare, he is bred to excel at jumping or dressage. He has been kept in regular work, and has been hacked out and ridden with other horses. Serious inquiries only please. 281-382-0766 Mary Nuttall	02/24/10
<b>FOR LEASE:</b> Gorgeous 9-year-old black Quarter Horse gelding, affectionate, easy to ride, well-trained in lower level dressage, reasonable lease rate with lessons available. Stabled at Willow Fork Ranch in Katy ( <a href="http://www.willowforkranch.com">www.willowforkranch.com</a> ). Call Sandra Adair at 281-395-4262 or email <a href="mailto:stadaird@comcast.net">stadaird@comcast.net</a> .	01/06/10
<b>FOR LEASE OR SALE:</b> Lovely Arabian chestnut gelding, gentle, bomb-proof, well-trained in dressage, reasonable lease rate and lessons available. Stabled at Willow Fork Ranch in Katy ( <a href="http://www.willowforkranch.com">www.willowforkranch.com</a> ). Call Sandra Adair at 281-395-4262 or email <a href="mailto:stadaird@comcast.net">stadaird@comcast.net</a> .	1/6/10
<b>TACK &amp; EQUIPMENT</b>	
Eurofit Shadbelly- Ladies-Navy- Size 14L-55% polyester/45% Wool- Never worn-\$250, Contact: Jeanette Snow at <a href="mailto:texasnowflake@hotmail.com">texasnowflake@hotmail.com</a>	03/25/10
<b>Trilogy Verago for sale - 17.5" MW.</b> Elite leather, great saddle with a deep seat and narrow twist. Two years old, great condition, \$2,700. 214-621-8830 or <a href="mailto:maurenjm@sbcglobal.net">maurenjm@sbcglobal.net</a> .	02/25/10
<b>Vaulting Surcingle</b> , literally brand new and never used, purchased from Charlotte's a couple of years ago. \$100 ph Mary Nuttall 281-382-0766	02/24/10
<b>Gorgeous 17.5 wide Borne Saddle.</b> Custom made deep seat with narrow twist for the rider. Open headed tree with ample wither clearance for the horse. Less than one year old. Unfortunately, horse outgrew. \$2500. Contact Pam Sutton 281/507-0743	2/15/10
<b>Wintec Isabell synthetic saddle</b> w/Cair panels and interchangeable gullet. 17" seat, double stitched, half hole stirrup leathers, MDC comfort irons, rubber lined reins, bridle, French link snaffle bit, and 2 schooling pads. All for \$800. Saddle alone \$500. All in excellent condition. Women's large, white FITS breeches, worn 4 times, \$150. Northampton English made dress boots, size 8.5, wide calf, \$100. Show pad \$20. Email for more info or pictures <a href="mailto:abeltma50@sbcglobal.net">abeltma50@sbcglobal.net</a>	02/02/10
<b>Wintec Pro Dressage Saddle. 17", Medium Tree.</b> Older model that has been well kept and is in excellent shape, but is a little faded. Comes with Stirrups and Stirrup Leathers. Perfect first saddle. Asking \$125. Contact Kristina Ehrle-Webb at 832-689-4169 or <a href="mailto:kristinaehrle@yahoo.com">kristinaehrle@yahoo.com</a>	01/04/10

## CLASSIFIEDS

<b>WORK OPPORTUNITY</b>	
<b>Dressage and/or hunter/jumper trainer/instructor wanted</b> for quality equine facility, conveniently located in Montgomery County near The Woodlands. Facility offers modern clean 12 x 12' stalls, warm water wash rack, individual or group paddock turnouts, covered dressage and open jump arenas. Nice sandy footing. For more information call 936.520.6156 or email <a href="mailto:jlhicks@consolidated.net">jlhicks@consolidated.net</a> .	01/16/10
<b>TRAILERS/TRUCKS</b>	
If you are looking for a new or used trailer, please visit <b>Gulf Coast 4 Star, located in Conroe Texas</b> . Gulf Coast 4 Star is the official trailer sponsor for The Houston Dressage Society. Two locations in Texas: I45 at Willis and I35 at Belton.	
<b>TRAINING/INSTRUCTION</b>	
<b>Sue Stone, USDF Bronze and Silver Medalist</b> . Lessons or Clinics at my farm or yours. One stall currently available, turnout, great covered arena with mirrors. Small, quiet facility in Cypress. 281-351-5883.	01/01/10
Have you ever wondered what does it feel to do Dressage with a high quality Pure Spanish Breed horse? Now it is your opportunity to discover the gentlest breed for this elegant discipline! <b>Woodlands Equestrian Club</b> has opened registration of its special program "Spanish School of Equestrian Arts". We are offering a 50% discount for your first lessons with the Int'l Gran Prix competitor Marta Renilla on one of these spectacular horses! Please visit <a href="http://www.woodlandsequestrianclub.com">www.woodlandsequestrianclub.com</a> for more info or call 832-330-6731 to schedule a lesson.	01/01/10
<b>FACILITIES/PROPERTIES</b>	
<b>Grand Oaks Equestrian Center</b> - Located just north of Alvin off Hwy 6, this picturesque facility is convenient to downtown Houston, Friendswood, Clear Lake and League City. A limited number of stalls are available for full board. The covered arena is 20x40 meters, well lit and has a combination of sand and rubber footing. Full sized dressage arena outdoors. More information available at <a href="http://www.grandoaksequestrian.com">www.grandoaksequestrian.com</a> or call Kim at 281-756-8461.	03/16/10
<b>Crowndale Farm in Sealy has a small two bedroom new house for lease</b> . Occasional part time work weekends and evenings in return for low rent. Stall for horse possible. Call 832-865-1122 for details.	02/17/10
<b>Private boarding facility</b> with controlled access gate in the Richmond/Katy area. Equestrian friendly features include: 28, 12 by 12 stalls, 100' by 200' lighted, covered arena with dressage layout and excellent footing, covered round pen, outdoor dressage/jumping arena, large turn out pastures, European horse walker, and a ¾ mile hunt course along Jones Creek. Professional services offered: dressage & jumper training, conditioning & sale preparation of horses, mare foaling & boarding, stallion handling, and collecting & shipping of semen. Performance Horses for sale of all ages and ability levels. Conveniently located 15 minutes from Great South West Equestrian Center and four miles from 99 Grand Parkway and the West Park Toll road. Call Mary at 281-344-0828 or email <a href="mailto:Mary@creekcolony.com">Mary@creekcolony.com</a> .	01/05/10
<b>ROSEHILL DRESSAGE</b> - Private competition barn has 3 stalls available for boarding. Covered arena with watering system, sand felt rubber footing and mirrors. Roundpen, jump chute, and large hayfield to ride around. Monthly clinics with Pati Pierucci who trained extensively with Robert Dover and Martin Schaudt. Enjoy our friendly relaxed atmosphere with a lovely country feel to it. All day turnout in grassy pastures. We feed whole foods and offer specialized individual care so that you have a happy healthy partner. Tomball. Contact Annie McChesney at 281-433-8208 or <a href="mailto:annie-14@sbcglobal.net">annie-14@sbcglobal.net</a>	01/01/10

# GULF COAST



Trailer Sales

OFFICIAL TRAILER SPONSOR  
OF THE HOUSTON DRESSAGE SOCIETY



**2 Horse Straight Load**  
**Gulf Coast 6' Weekend Package LQ**

- 3-Swing Out Saddle Racks
- All-Aluminum Shower & Sink
- Refrigerator & Microwave
- Clothes Hooks & Helmet Shelf
- A/C w/Heat Strip & Insulated Roof

**\$32,200.00**

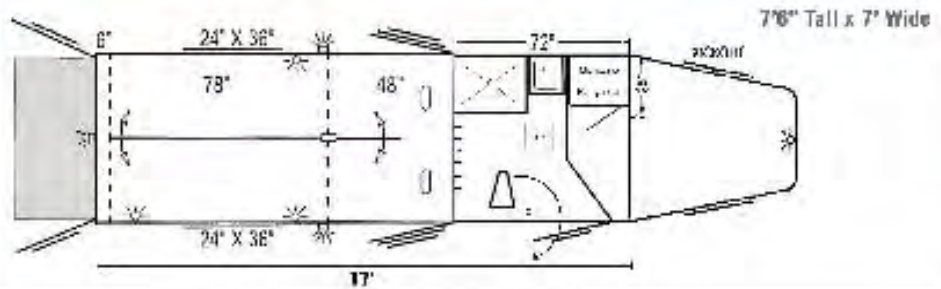

**2 Horse Straight Load**  
**7' Proline LQ & Mid Tack**

- Bathroom w/Shower & Toilet
- Full Mattress
- Refrigerator & Microwave
- A/C & Ducted Furnace
- 2 Saddle Racks in Mid Tack

**\$39,900.00**

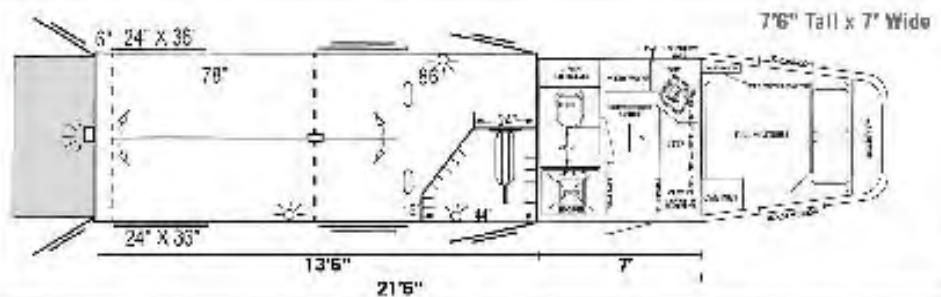

**2 Horse Straight Load**  
**9' Outlaw LQ & Mid Tack**

- 5' Mid Tack w/Walk Thru Doors
- Bathroom w/Shower & Toilet
- Queen Mattress
- 6' Sofa Sleeper w/Table
- Refrigerator & Microwave
- Ducted A/C & Furnace

**\$58,900.00**

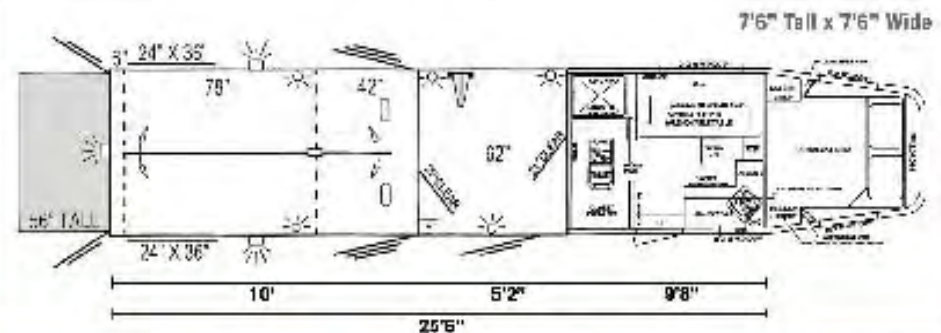

Gulf Coast 4 Star is here to provide only the best in sales and service. We are your source for oversized straight load horse trailers. Visit us online to see our entire inventory of all-aluminum 4-Star straight load trailers.



Outlaw Conversions



Proline Interiors



Gulf Coast LQ Package



17425 HWY 75 Willis, Texas 77378 Tel 936.344.0200 Toll free 877.543.0733

[gc4star.com](http://gc4star.com)

**Collective Remarks** is a  
Monthly Publication of Houston  
Dressage Society, Inc., a non-  
profit tax exempt corporation

**Submissions of articles from  
HDS Members is encouraged**

**Editor**

Jeanette Snow  
281-533-0371

[texasnowflake@hotmail.com](mailto:texasnowflake@hotmail.com)



**Hans Jurgen Boone**

Classical  
Dressage

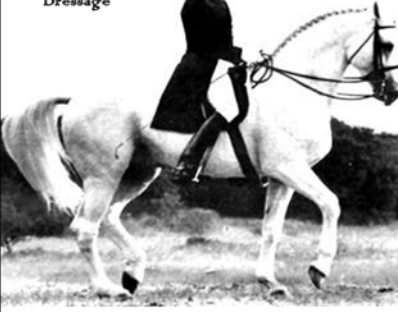

USDE BRONZE, SILVER, GOLD MEDAL RIDER

*12x12 stalls with automated watering systems. Two full-size covered, lighted, furnished arenas. One covered, lighted 20-meter roundpen one large, lighted outdoor arena. Full-service facility with exceptional care and training.*

[hansboone@sbcglobal.net](mailto:hansboone@sbcglobal.net)

---

IRISH DAY FARM, INC. 9510 WINDFERN RD. HOUSTON, TX  
77064-7740 713.896-0258 BARN 713.899-0155 MOBILE

# HDS BOARD MEMBERS

**President**

Kathy Jones  
[kkj3156@sbcglobal.net](mailto:kkj3156@sbcglobal.net)  
281-955-0803

**Clinics/Education/Scholarships**

Karen Sannan  
[Karen\\_Sannan@yahoo.com](mailto:Karen_Sannan@yahoo.com)

**Recognized Shows**

Kathy Jones  
[kkj3156@sbcglobal.net](mailto:kkj3156@sbcglobal.net)  
281-955-0803

**Vice President**

Cal Eller  
[celler78@aol.com](mailto:celler78@aol.com)  
281-723-4009

**Junior/Young Riders**

Sandra Kinkead  
[HDSjuniors@gmail.com](mailto:HDSjuniors@gmail.com)  
281-450-7853

**Schooling Shows**

Lynda Langston  
[lynda.langston@yahoo.com](mailto:lynda.langston@yahoo.com)  
713-806-4923

**Membership**

Karen Peacock  
210-872-8628  
[peacocktx@gmail.com](mailto:peacocktx@gmail.com)

**Awards Chair**

Laurie Jackson  
[ljackso2@aol.com](mailto:ljackso2@aol.com)  
713-471-5775

**Historian/Recorder**

Karen Roepke  
[karenroepke@gmail.com](mailto:karenroepke@gmail.com)  
713-503-0363

**Secretary**

Charles Saltzer  
[charles\\_chessie@yahoo.com](mailto:charles_chessie@yahoo.com)  
281-793-8197

**Special Events**

Sylvia Workman  
[s.workman01@yahoo.com](mailto:s.workman01@yahoo.com)  
936-321-5196

**Volunteer Coordinator**

Jane Holman  
[janeintheneck@aol.com](mailto:janeintheneck@aol.com)

**Treasurer**

Margaret Dhont  
[mddhont@hotmail.com](mailto:mddhont@hotmail.com)  
713-662-2887

**Publications/Website**

Jeanette Snow  
[texasnowflake@hotmail.com](mailto:texasnowflake@hotmail.com)  
281-533-0371

**Advertising & Sponsorship**

Nisse Pedigo  
[xhaltfarms@gmail.com](mailto:xhaltfarms@gmail.com)